

Bulkhead coupler

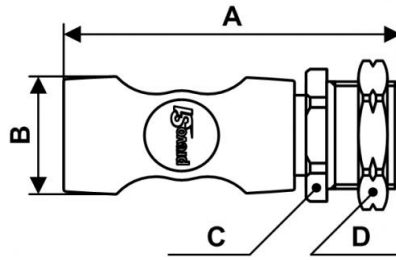

<p><u>NPT female thread</u> 1/2" FNPT</p>	<p><u>Drill Ø (in)</u> 1.06</p>	<p><u>Panel depth (in)</u> 0.43</p>	<p><u>Technology</u> "One push" safety system (avoids hose whip)</p>
<p><u>Operating pressure</u> 29 to 174 psi</p>	<p><u>Flow rate at 100 psi</u> 81 cfm ($\Delta P = 10$ psi)</p>	<p><u>ID Passage</u> 3/8" body size</p>	<p><u>Temperature</u> +5°F to +158°F</p>
<p><u>Construction</u> Composite body</p>	<p><u>Highlight</u> Anti-static Non scratch</p>		

Description			
Reference	NPT female thread	Drill Ø (in)	Panel depth (in)
ISI 082203	1/2" FNPT	1.06	0.43



Dimensions

Reference	A inch	B inch	C inch	D inch
ISI 082203	0.31824146981627	0.10826771653543	0.095144356955381	0.10498687664042