

## Hose stem coupler



### For hose ID

3/8" Hose barb

### Technology

"One push" safety system  
(avoids hose whip)

### Operating pressure

29 to 174 psi

### Flow rate at 100 psi

148 cfm ( $\Delta P = 8.70$  psi)

### ID Passage

1/2" body size

### Temperature

+5°F to +158°F

### Construction

Polyamide composite body

### Highlight

Anti-static Excellent  
efficiency Non scratch

Description	
Reference	For hose ID
<b>ISI 111810EB</b>	3/8" Hose barb
<b>ISI 111813EB</b>	1/2" Hose barb
<b>ISI 111816EB</b>	5/8" Hose barb
<b>ISI 111819EB</b>	3/4" Hose barb

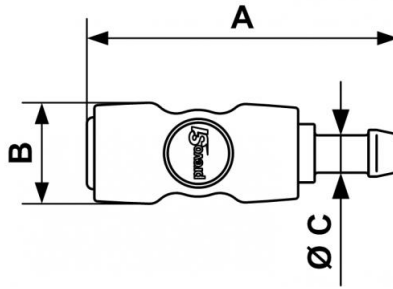

### Dimensions

Reference	A inch	B inch	C inch
<b>ISI 111810EB</b>	0.3740157480315	0.12139107611549	0.032808398950131
<b>ISI 111813EB</b>	0.39370078740157	0.12139107611549	0.042650918635171
<b>ISI 111816EB</b>	0.39370078740157	0.12139107611549	0.05249343832021
<b>ISI 111819EB</b>	0.4757217847769	0.12139107611549	0.062335958005249